

The EQA lance type burners have been designed specially for cooking ovens vertically tunnels downstream (Example: Hoffmann type furnaces), mainly used for the manufacturing of red ceramic (holes, tiles, etc). This equipment is constituted by a car air and gas distributor in which we can find the centrifugal fan, air butterfly valves, gas pressure gauge, main gas inlet valve, connection and air and gas hoses to couple to the burners that are introduced in the furnace.

Each burner is composed of an external pipe for the air and an internal pipe for the gas, they are mixed in the nozzle or (inferior end), the length of the flame can be regulated automatically without any change in the air-gas proportion.

Each burner also has a support plate used to regulate the deepness into which the furnace is put through and a visor that allows you to see the flame clearly. The part of the burner which are put into high temperatures, external pipe, interior, injector and nozzle, are made of type AISI 310 stainless steel.



#### Operation

Burners can work with low or high pressure gas (about 2 bar), with a high performance, reaching heat uniformity in the baking zone.

To change the cart to other baking zone, once the burners and fan are turned, the quick couplings must be disconnected and the elements carried separately.

As optional accessories, they can be equipped with pressure gauges for air pressure gas filter, control board with pyrometer and thermocouple and solenoid valve to control the temperature.

Burners for Hoffmann Type Furnaces

# EQA 600

## EQA 600 Components of Hoffmann Equipment

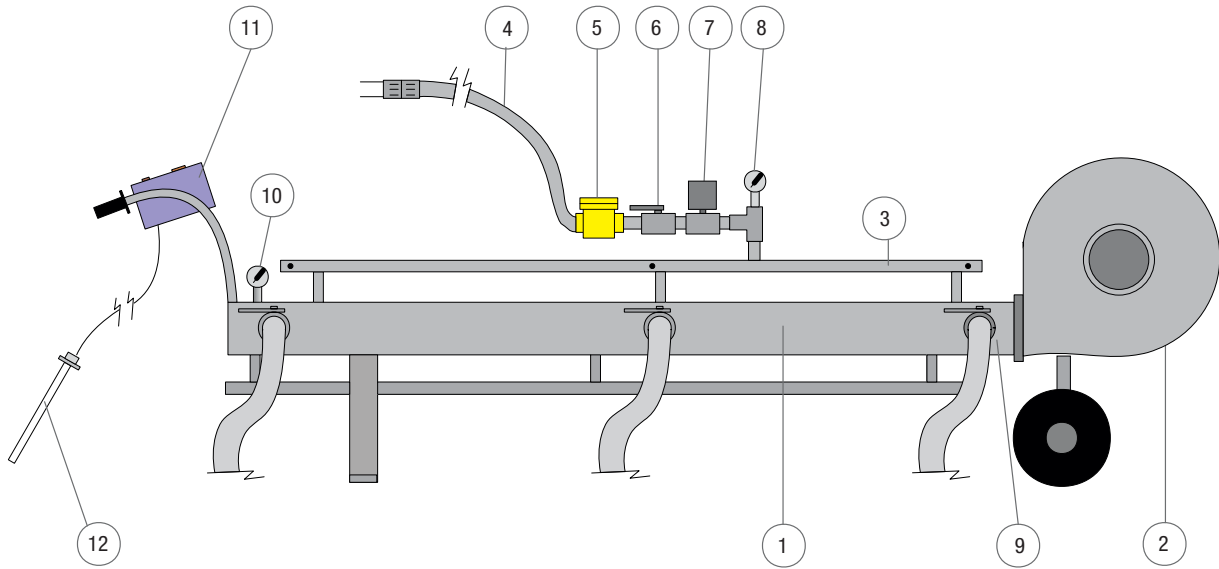

## EQA 600 Components with Each Burner

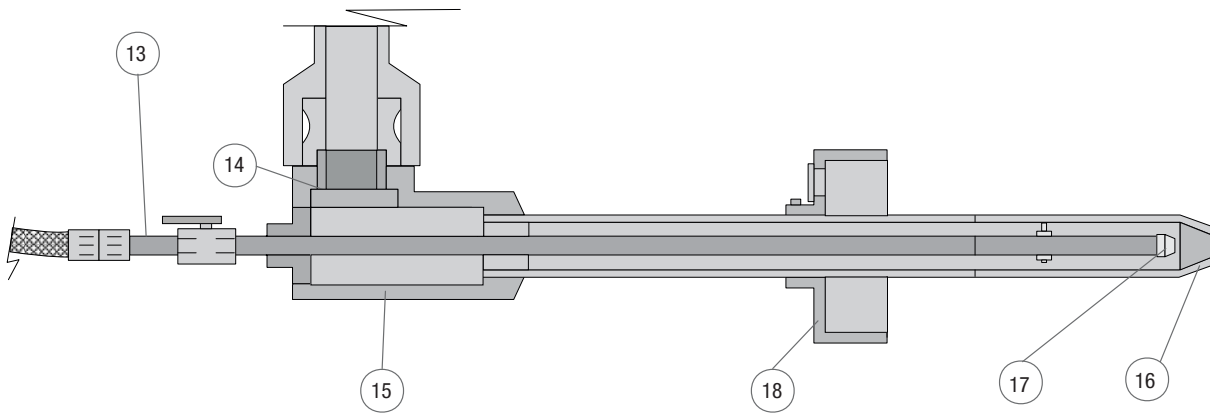

Position	Description
1	Air distributor pipe
2	Centrifugal fan
3	Gas distributor tube
4	Gas inlet hose with coupling
5	Gas filter (optional)
6	Spherical key gas
7	Solenoid valve gas (optional)
8	Manometer gas pressure
9	Vents with butterfly regulation

Position	Description
10	Air manometer (optional)
11	Box control G.N. and functioning (optional)
12	Thermocouple of temperature control (optional)
13	Input burner gas, with fast couple and gas key
14	Input burner air
15	Burner body
16	Cone and duct stainless steel
17	Injector and duct gas of stainless steel
18	Support plate of burner with flame visor (viewer)

### EQA S.A.I.C.

26 de abril 3836 - ITUZAINGO (1714) - Pcia. de Buenos Aires  
 Tel. (54 11) 4481-9950 y rotativas / Fax.(54 11) 4481-9288  
 e-mail: eqa@eqa.com.ar - web site: www.eqa.com.ar

### DISTRIBUIDOR | DISTRIBUTOR